



Off-The-Glass

Consolidate, integrate... and simplify.

Your school has likely had a system for charging students for copies for years. But as you implement Pharos Uniprint to recover student, faculty, and staff printing costs, it makes good business sense to update your copy-charging system to form a single, consolidated, document output solution. Using Uniprint in conjunction with Pharos Off-The-Glass, students and faculty have one convenient payment/bill-back method for both printing and copying, your IT staff has a single, centralized point of administration and control, and your school has the same comprehensive support from a proven and trusted technology partner in the higher education market.

Off-The-Glass is yet another example of how Pharos never stops working to find new ways for your school to recover costs, eliminate waste, and take control over your document output.

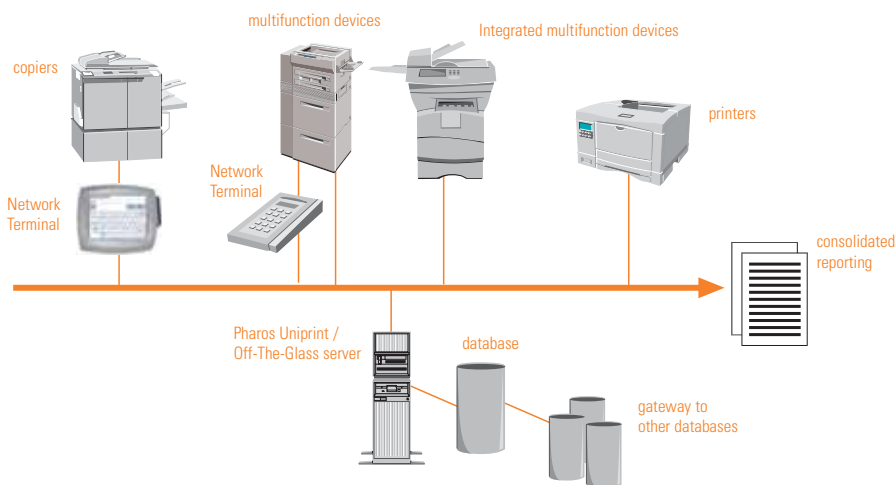

Network Terminals record copy transactions and incorporate data with information retrieved from network printing. They may also be used as Release Stations for printing. Additionally, Off-The-Glass is resident directly on the user interface of certain integrated multifunction devices for seamless tracking, accounting, and print release.

Key features and benefits

- *Tracks user-based copy activities and usage so in an instant, you will know who made the copies, how many copies were made, from which copier, and which account (if any) should be charged.*
- *Charges back copying to departments, by faculty name/number, by grant, or by one or more student accounts, allowing you to prevent copying abuse and waste while recovering costs.*
- *Provides nine copy reports, four transaction reports, and eight 3rd-party charging reports, so you have the exact, accurate information you need to make good decisions. Reporting can be integrated with a full license of customizable Crystal Reports, enabling you to obtain all the information you require while maximizing your current investment in reporting technology.*
- *A flexible charging model gives you the ability to bill variable amounts based on selected copy features available via the vendor's FDI (eg. color, duplex, and paper size).*
- *Supports all major manufacturers of copiers and multifunction devices, which ensures a seamless fit into your existing environment. Off-The-Glass is also available embedded directly in the user interface of select multifunction printers.*
- *Integrates seamlessly with the most common online Logon and Billing systems as well as Pharos Uniprint to capture and consolidate all student and faculty user-based document output activity within a single database.*
- *Enables more informed purchasing decisions, optimized technology, lower operating costs, and improved worker productivity and student satisfaction.*



Pharos Systems –

Pharos Systems has a worldwide network of technical specialists who come to your site and customize the solution for your unique requirements. In a short time, the software is up and running, working side by side with your existing technology without disrupting your current workflow. Pharos also provides comprehensive e-mail and phone support to help staff and end users overcome any challenges as soon as they arise.

Specs

Pharos Principal Server

Operating Systems	Windows 2003 Server/2000/NT 4.0
CPU/ Memory	Pentium 4/Athlon 64, 512 MB RAM, 120 GB disk space
Network Connectivity	TCP/IP Network Protocol
Database	Microsoft SQL Server 2005/2000/7.0 or Microsoft MSDE

Pharos Print Server

Operating Systems	Windows 2003 Server/XP Professional/2000/ NT 4.0
CPU/ Memory	Pentium 4/Athlon 64, 512 MB RAM, 120 GB disk space
Network Connectivity	TCP/IP Network Protocol

Pharos Station Application

Operating Systems	Windows 2003 Server/ 2000/ XP Professional/NT 4.0
CPU/ Memory	Pentium I+ or Celeron 64+ MB of RAM 100 MB or higher of disk space
Network Connectivity	TCP/IP Network Protocol
Browser	Microsoft Internet Explorer 5.0 or later

Pharos Reports Application

Operating Systems	Windows XP/ 2000/ NT 4.0/ Me/ 98/ 95
CPU/ Memory	Pentium II+ 64+ MB of RAM 500+ MB of disk space
Network Connectivity	TCP/IP Network Protocol

Copying Devices

Off-The-Glass supports a wide range of analog and digital copiers, as well as MFDs/MFPs. Contact an Authorized Pharos Systems Reseller to see if your devices are supported.

MFDs/MFPs

Supported copy control devices	Pharos Omega BEAR POD Virtual Cash Network Terminal Station PS20
Supported account maintenance devices	Pharos Copy Station (PC) Virtual Cash Autoloader (for funds transfer) Pharos Systems Kiosk

Card Readers

Off-The-Glass supports both magnetic stripe and bar code identification cards. If charging is implemented, Off-The-Glass can be configured to allow users to transfer funds from a cash card. Card interfaces are being developed all the time. Check with an Authorized Pharos Systems Reseller for the latest compatibility list.

Online Logon and Billing Systems

Online Billing Systems	Blackboard Transaction Systems CBORD Odyssey Diebold CSGold (ETI)
Online Logon Systems	Innovative Dynix SIRSI SIP2 compliant

The Pharos Professional Services group or our Value Added Resellers will work directly with you to determine the exact specifications required to meet the needs of your unique installation.

